

George Bourne and Associates  
73 Elm Street (PO Box 169) Barcaldine Qld 4725  
Phone: 07 4651 5177 Fax: 07 3220 6791  
Email: admin@gbassoc.com.au

**LIVE DATA** Current as of  
**7 September 2018**

Disclaimer: While every care is taken to ensure the accuracy of this product, George Bourne and Associates make no representations or warranties about its accuracy, reliability, completeness or suitability for any particular purpose and disclaims all responsibility and all liability (including without limitation, liability in negligence) for all expenses, losses, damages (including indirect or consequential damage) and costs which you might incur as a result of the product being inaccurate or incomplete in any way and for any reason.

**DRAWING INDEX**

BOU-W1:      Boulia Water (Town)  
BOU-W2:      Boulia Water (Effluent Ponds)  
BOU-W3:      Boulia Water Details

**NOTES**

NO.	LOCATION
001	Bore No. 1 - Decommissioned
002	Bore No. 2 - Decommissioned
003	New Elevated Reservoir 314kl, 26m High
004	New Pump Station
005	Ground Reservoir, 1100kl R.C. Tank
006	Bore No.5
007	Bore No.4 Replaced By Bore No.8
008	South End Wills Street
009	Bore No.3 Replaced By Bore No.7
010	25mm Poly To Aerodrome
011	50mm Poly To Butchers
012	50mm Raw Water For Median Strip Irrigation
013	100mm Blue Brute
014	Main Follows S Bend Of Footpath
015	50mm Blue Line Poly To River Properties
016	Power House Bore
017	Bore No. 3 Abandoned, RN 51615
018	Existing 50mm Poly Service Line To Paddock And Cemetery
019	For Connection To Future Connections
020	330m Of 100mm Main To Native Affairs Establishment
021	Median Strip
022	Median Strip
023	Washdown Bay Bore No. 9
024	Bore No. 4 Abandoned, RN 69551
025	SES Bore No. 8
026	Wash Down Bay
027	Cross Connection with NRV

**LEGEND**

200Ø PN16 Poly	---
160Ø PN16 Poly	-.-.-
150Ø Iron Ductile	---
150Ø PE	---
25Ø Poly	---
50Ø Poly	---
100Ø Poly	---
110Ø Reticulation	---
Bore	●
Hydrant	●
Water Valve	⋈
Scour Valve	⋈
Dist. from Boundary	↑ 6.7m

Client:      **Boulia Shire Council**

Project:      **Boulia - Live Data**

Title:      **Boulia Water (Town)**

Category: Water

Project-Set: Boulia	Sheet: 01 OF 02
Drawing No. <b>BOU-W1</b>	Scale: AS SHOWN Size: A3

Date Printed: 07/09/2018 10:25:16 M-Files ID: 232279





Date Printed: 07/09/2018 10:25:18 M-Files ID: 232279

George Bourne and Associates  
73 Elm Street (PO Box 169) Barcaldine Qld 4725  
Phone: 07 4651 5177 Fax: 07 3220 6791  
Email: admin@gbassoc.com.au

**LIVE DATA** Current as of  
**7 September 2018**

Disclaimer: While every care is taken to ensure the accuracy of this product, George Bourne and Associates make no representations or warranties about its accuracy, reliability, completeness or suitability for any particular purpose and disclaims all responsibility and all liability (including without limitation, liability in negligence) for all expenses, losses, damages (including indirect or consequential damage) and costs which you might incur as a result of the product being inaccurate or incomplete in any way and for any reason.

**NOTES**

NO.	LOCATION

<p><b>LEGEND</b></p> <p>200Ø PN16 Poly</p> <p>160Ø PN16 Poly</p> <p>150Ø Iron Ductile</p> <p>150Ø PE</p> <p>25Ø Poly</p> <p>50Ø Poly</p> <p>100Ø Poly</p> <p>110Ø Reticulation</p> <p>Bore</p> <p>Hydrant</p> <p>Water Valve</p> <p>Scour Valve</p> <p>Dist. from Boundary</p>	<p>---</p> <p>-.-.-</p> <p>---</p> <p>---</p> <p>---</p> <p>---</p> <p>---</p> <p>---</p> <p>⊙</p> <p>⊙</p> <p>⊗</p> <p>⊗</p> <p>↑ 6.7m</p>
--	---

Client: **Boulia Shire Council**

Project: **Boulia - Live Data**

Title: **Boulia Water (Effluent Ponds)**

Category: Water	
Project-Set: Boulia	Sheet: 01 OF 02
Drawing No.	Scale: AS SHOWN
<b>BOU-W2</b>	Size: A3

















LIVE DATA Current as of  
7 September 2018

Disclaimer: While every care is taken to ensure the accuracy of this product, George Bourne and Associates make no representations or warranties about its accuracy, reliability, completeness or suitability for any particular purpose and disclaims all responsibility and all liability (including without limitation, liability in negligence) for all expenses, losses, damages (including indirect or consequential damage) and costs which you might incur as a result of the product being inaccurate or incomplete in any way and for any reason.

NOTES

- 200mm line transfers to below ground approx. 3m before fenceline.
- 25mm poly line to airport and 100mm line to butchers paddock
- 4m of 160mm PE

LEGEND

200Ø Water Mains	
160Ø PN16 Poly	
160Ø Reticulation	
150Ø Iron Ductile	
25Ø Poly	
50Ø Poly	
100Ø Poly	
110Ø Reticulation	
Bore	
Hydrant	
Water Valve	
Scour Valve	
Dist. from Boundary	

Client: Boulia Shire Council

Project: Boulia - Live Data

Title: Boulia Water Details

Category: Water

Project-Set: Boulia

Sheet: 02 OF 02

Drawing No.

Scale: AS SHOWN

BOU-W3

Size: A3

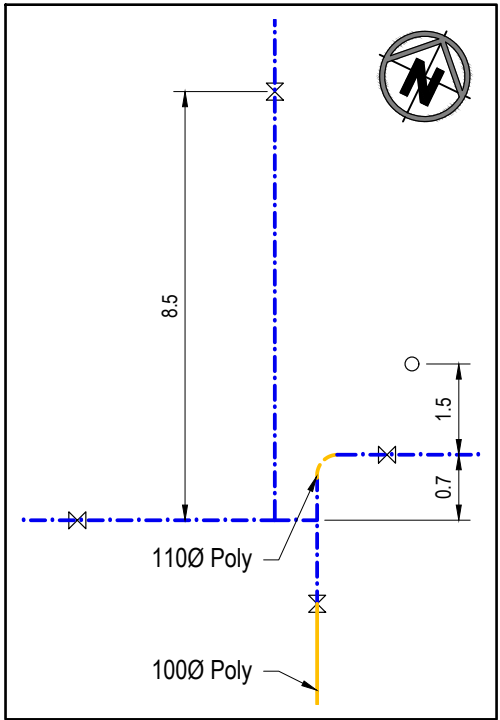

DETAIL A: CONNECTION DETAIL

NTS

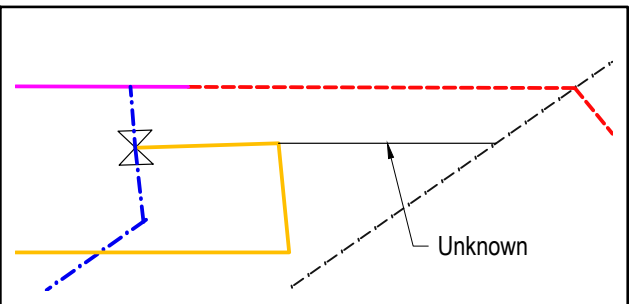

DETAIL C: CONNECTION DETAIL

NTS

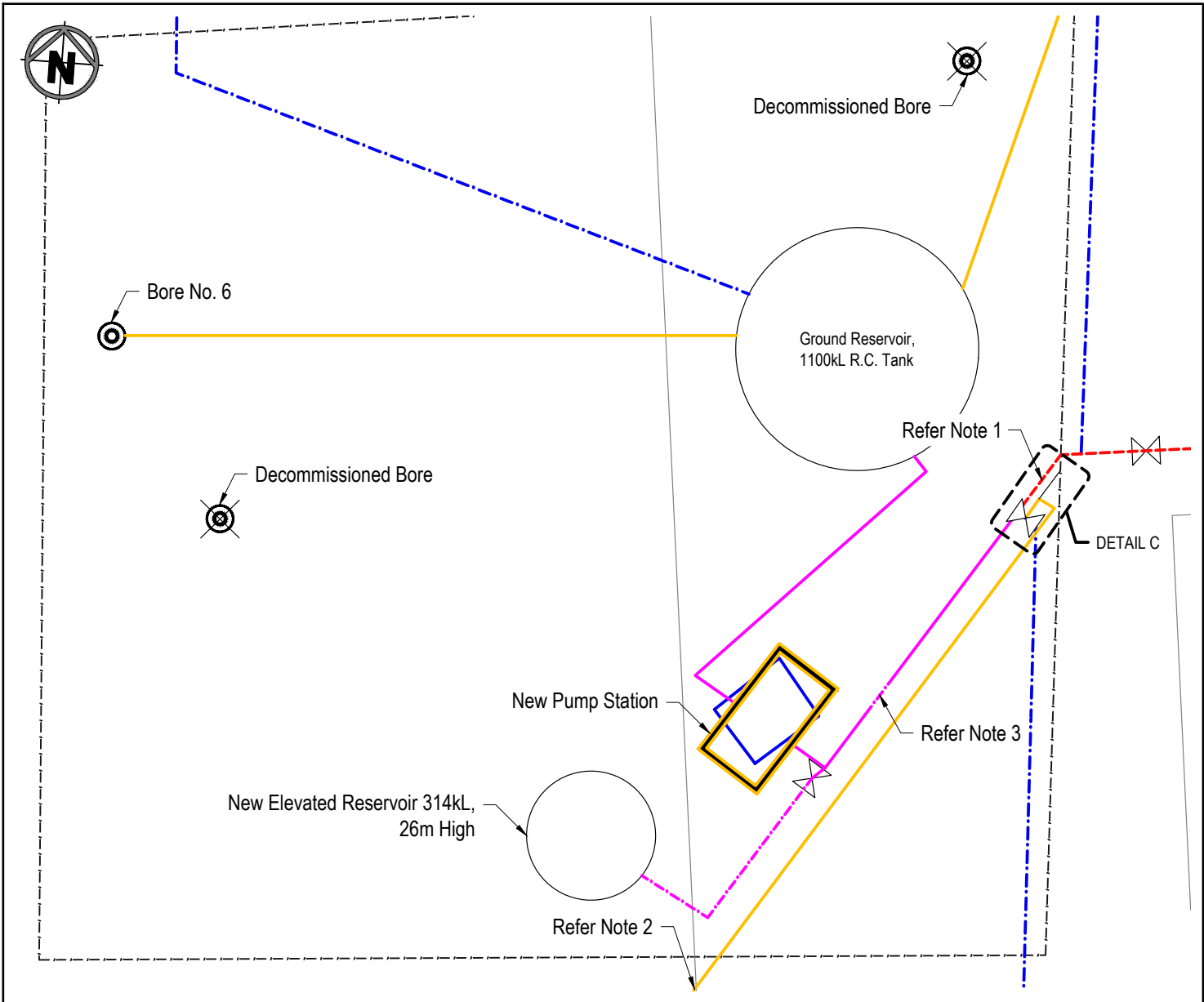

DETAIL B: PUMP STATION AND RESERVOIRS

NTS





**Disclaimer:**

**Queensland Digital Cadastral Data Base**  
Based on or contains data provided by the State of Queensland (Department of Environment and Resource Management) [2010]. In consideration of the State permitting use of this data you acknowledge and agree that the State gives no warranty in relation to the data (including accuracy, reliability, completeness, currency to suitability) and accepts no liability (including without limitation, liability in negligence) for any loss, damage or costs (including consequential damage) relating to any use of the data. Data must not be used for direct marketing or be used in breach of the privacy laws.

**General**  
The Infrastructure Data shown on this map has been provided by Council and / or the State of Queensland. In this regard, Campbell Higginson Town Planning makes no guarantees, either expressed or implied as to the completeness, accuracy or correctness of the data nor accepts any liability arising from any incorrect, incomplete information contained within.

**Legend:**

- Property Boundary
- Water Main
- Water Supply Service Catchment

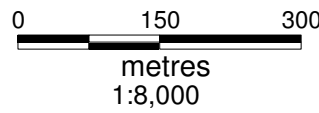

**Amendments:**

Planning Scheme Version:  
Version 2  
Effective as of 30 January 2015  
Consolidated - Incorporating Amendment No. 1.

© Campbell Higginson Town Planning Pty Ltd 2003 - 2015  
Copyright protects this publication. Campbell Higginson Town Planning has no objection to this material being reproduced, made available online or electronically but only if it is recognized as the owner of the copyright and this material remains unaltered.

**BOULIA SHIRE COUNCIL  
TRUNK INFRASTRUCTURE  
WATER SUPPLY**



**TOWN OF URANDANGI**

Drawn by: <b>S.G.S.</b>	Drawing No:
Date: <b>04 - 06 - 12</b>	<b>SHEET 4 OF 8</b>
Ref: <b>22WAT2</b>	

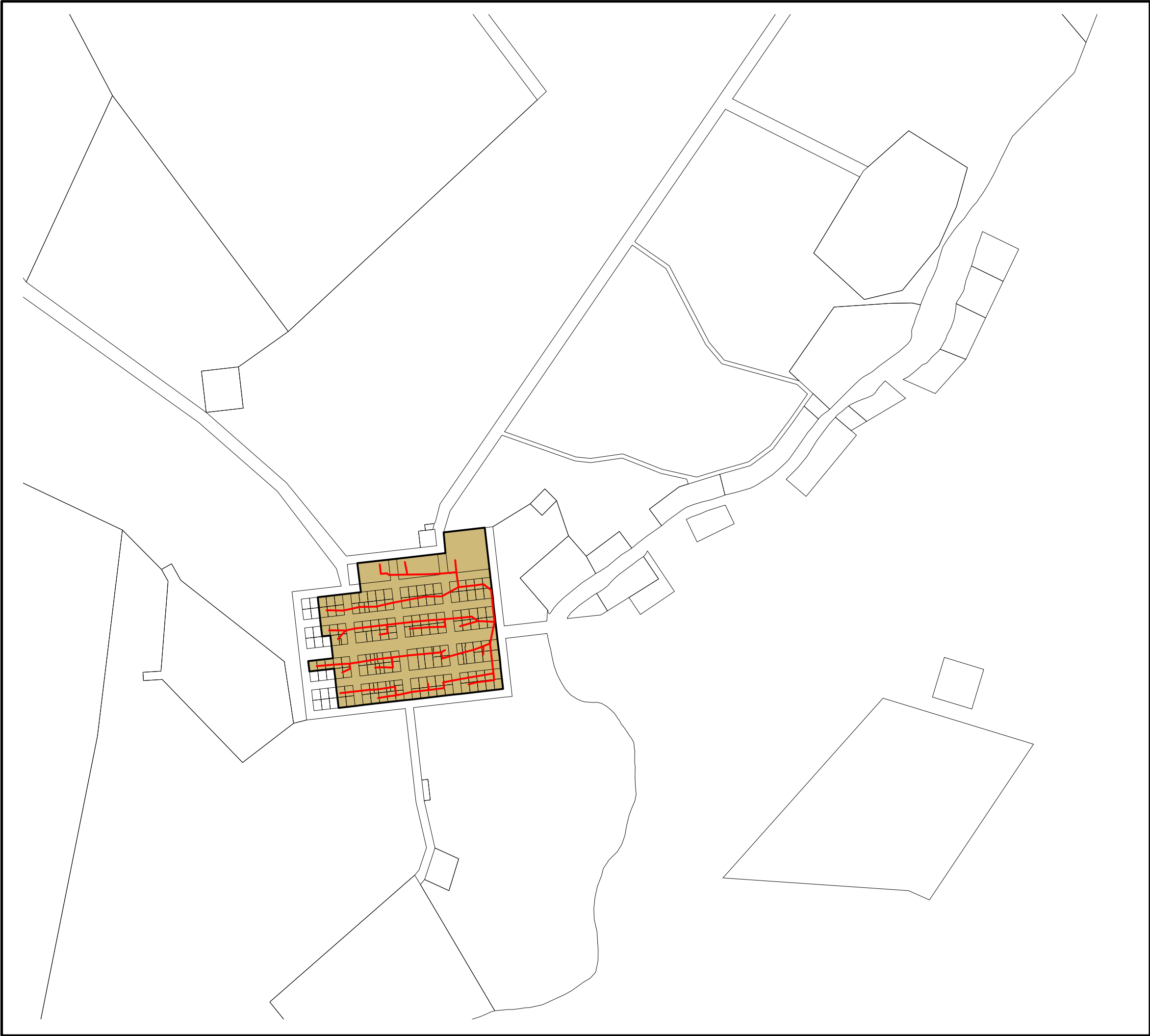



**Disclaimer:**  
Queensland Digital Cadastral Data Base  
Based on or contains data provided by the State of Queensland (Department of Environment and Resource Management) [2010]. In consideration of the State permitting use of this data you acknowledge and agree that the State gives no warranty in relation to the data (including accuracy, reliability, completeness, currency to suitability) and accepts no liability (including without limitation, liability in negligence) for any loss, damage or costs (including consequential damage) relating to any use of the data. Data must not be used for direct marketing or be used in breach of the privacy laws.  
General  
The Infrastructure Data shown on this map has been provided by Council and / or the State of Queensland. In this regard, Campbell Higginson Town Planning makes no guarantees, either expressed or implied as to the completeness, accuracy or correctness of the data nor accepts any liability arising from any incorrect, incomplete information contained within.

- Legend:**
-  Property Boundary
  -  Sewerage Main
  -  Sewerage Service Catchment

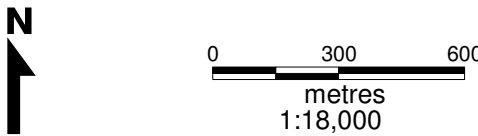

**Amendments:**

**Planning Scheme Version:**  
Version 2  
Effective as of 30 January 2015  
Consolidated - Incorporating Amendment No. 1.

© Campbell Higginson Town Planning Pty Ltd 2003 - 2015  
Copyright protects this publication. Campbell Higginson Town Planning has no objection to this material being reproduced, made available online or electronically but only if it is recognized as the owner of the copyright and this material remains unaltered.

**BOULIA SHIRE COUNCIL  
TRUNK INFRASTRUCTURE  
SEWERAGE**

**TOWN OF BOULIA**



Drawn by: <b>S.G.S.</b>	<b>SHEET 5 OF 8</b>
Date: <b>04 - 06 - 12</b>	
Ref: <b>22SEW1</b>	

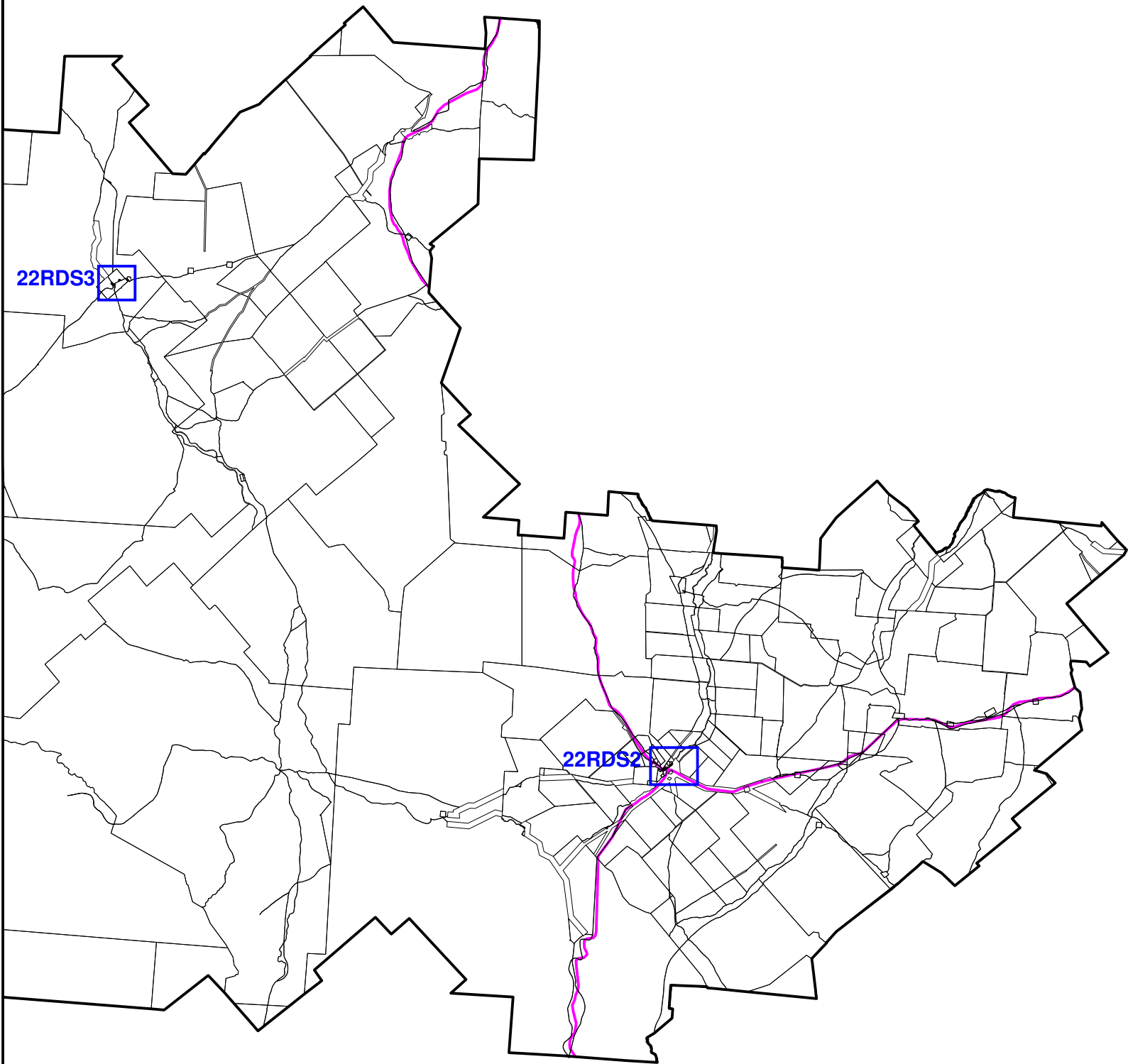

NORTHERN TERRITORY



**Disclaimer:**  
Queensland Digital Cadastral Data Base  
Based on or contain data provided by the State of Queensland (Department of Environment and Resource Management) [2010]. In consideration of the State permitting use of this data you acknowledge and agree that the State gives no warranty in relation to the data (including accuracy, reliability, completeness, currency to suitability) and accepts no liability (including without limitation, liability in negligence) for any loss, damage or costs (including consequential damage) relating to any use of the data. Data must not be used for direct marketing or be used in breach of the privacy laws.  
General  
The Infrastructure Data shown on this map has been provided by Council and / or the State of Queensland. In this regard, Campbell Higginson Town Planning makes no guarantees, either expressed or implied as to the completeness, accuracy or correctness of the data nor accepts any liability arising from any incorrect, incomplete information contained within.

- Legend:**
-  Property Boundary
  -  State Controlled Road
  -  Detailed Map and Sheet Reference



Amendments:

Planning Scheme Version:  
Version 2  
Effective as of 30 January 2015  
Consolidated - Incorporating Amendment No. 1.

© Campbell Higginson Town Planning Pty Ltd 2003 - 2015  
Copyright protects this publication. Campbell Higginson Town Planning has no objection to this material being reproduced, made available online or electronically but only if it is recognized as the owner of the copyright and this material remains unaltered.

**BOULIA SHIRE COUNCIL  
TRUNK INFRASTRUCTURE  
TRANSPORT**

**LOCAL GOVERNMENT AREA  
BOULIA SHIRE**

Drawn by: <b>S.G.S.</b>	Drawing No:  <b>SHEET 6 OF 8</b>
Date: <b>04 - 06 - 12</b>	
Ref: <b>22RDS1</b>	



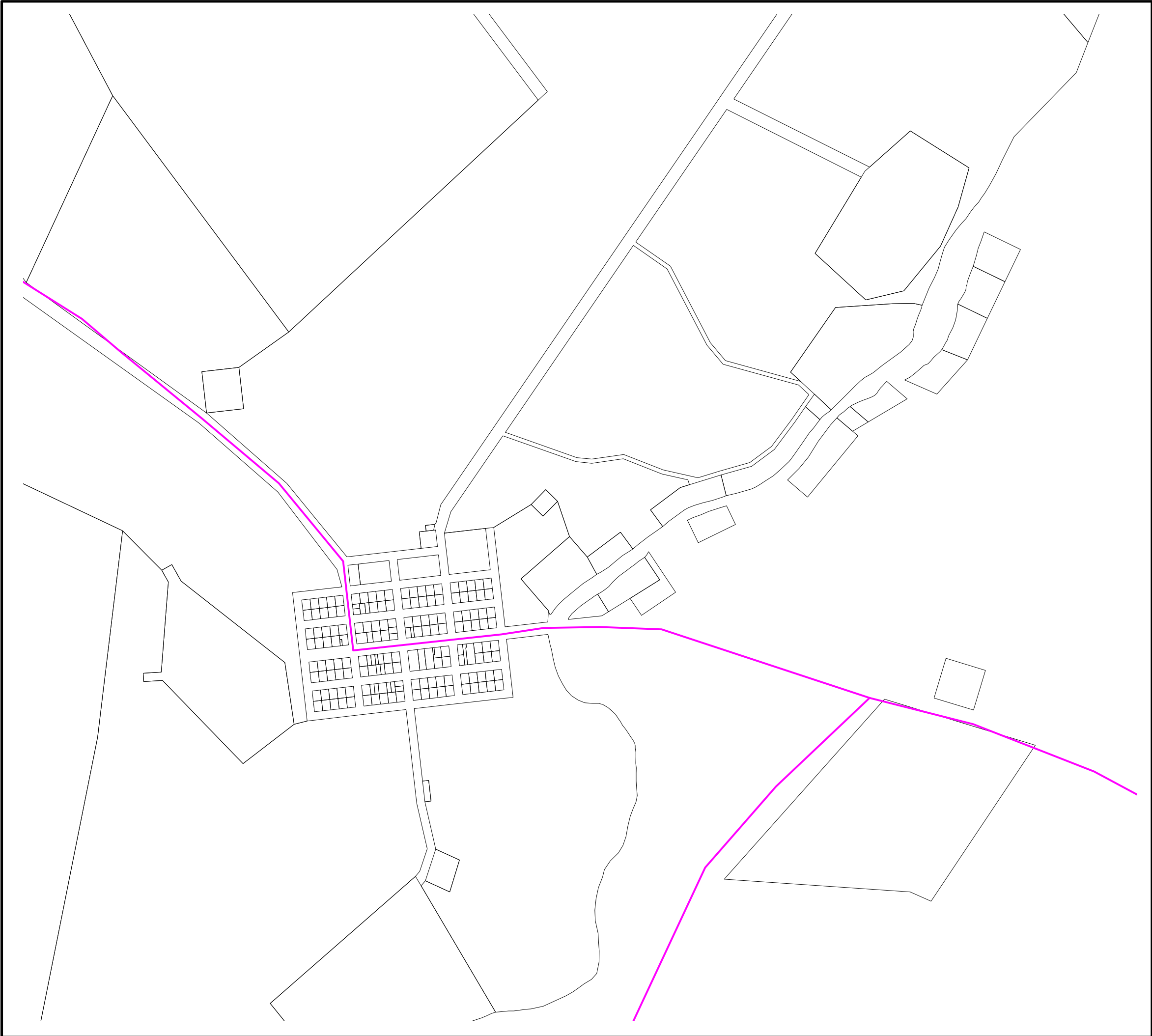

**Disclaimer:**  
Queensland Digital Cadastral Data Base  
Based on or contains data provided by the State of Queensland (Department of Environment and Resource Management) [2010]. In consideration of the State permitting use of this data you acknowledge and agree that the State gives no warranty in relation to the data (including accuracy, reliability, completeness, currency to suitability) and accepts no liability (including without limitation, liability in negligence) for any loss, damage or costs (including consequential damage) relating to any use of the data. Data must not be used for direct marketing or be used in breach of the privacy laws.  
General  
The Infrastructure Data shown on this map has been provided by Council and / or the State of Queensland. In this regard, Campbell Higginson Town Planning makes no guarantees, either expressed or implied as to the completeness, accuracy or correctness of the data nor accepts any liability arising from any incorrect, incomplete information contained within.

**Legend:**

-  Property Boundary
-  State Controlled Road

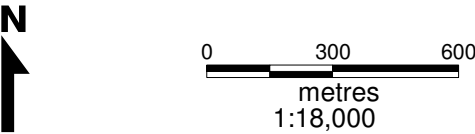

**Amendments:**

Planning Scheme Version:  
Version 2  
Effective as of 30 January 2015  
Consolidated - Incorporating Amendment No. 1.

© Campbell Higginson Town Planning Pty Ltd 2003 - 2015  
Copyright protects this publication. Campbell Higginson Town Planning has no objection to this material being reproduced, made available online or electronically but only if it is recognized as the owner of the copyright and this material remains unaltered.

**BOULIA SHIRE COUNCIL  
TRUNK INFRASTRUCTURE  
TRANSPORT**

**TOWN OF BOULIA**



Drawn by: <b>S.G.S.</b>	Drawing No:  <b>SHEET 7 OF 8</b>
Date: <b>04 - 06 - 12</b>	
Ref: <b>22RDS2</b>	

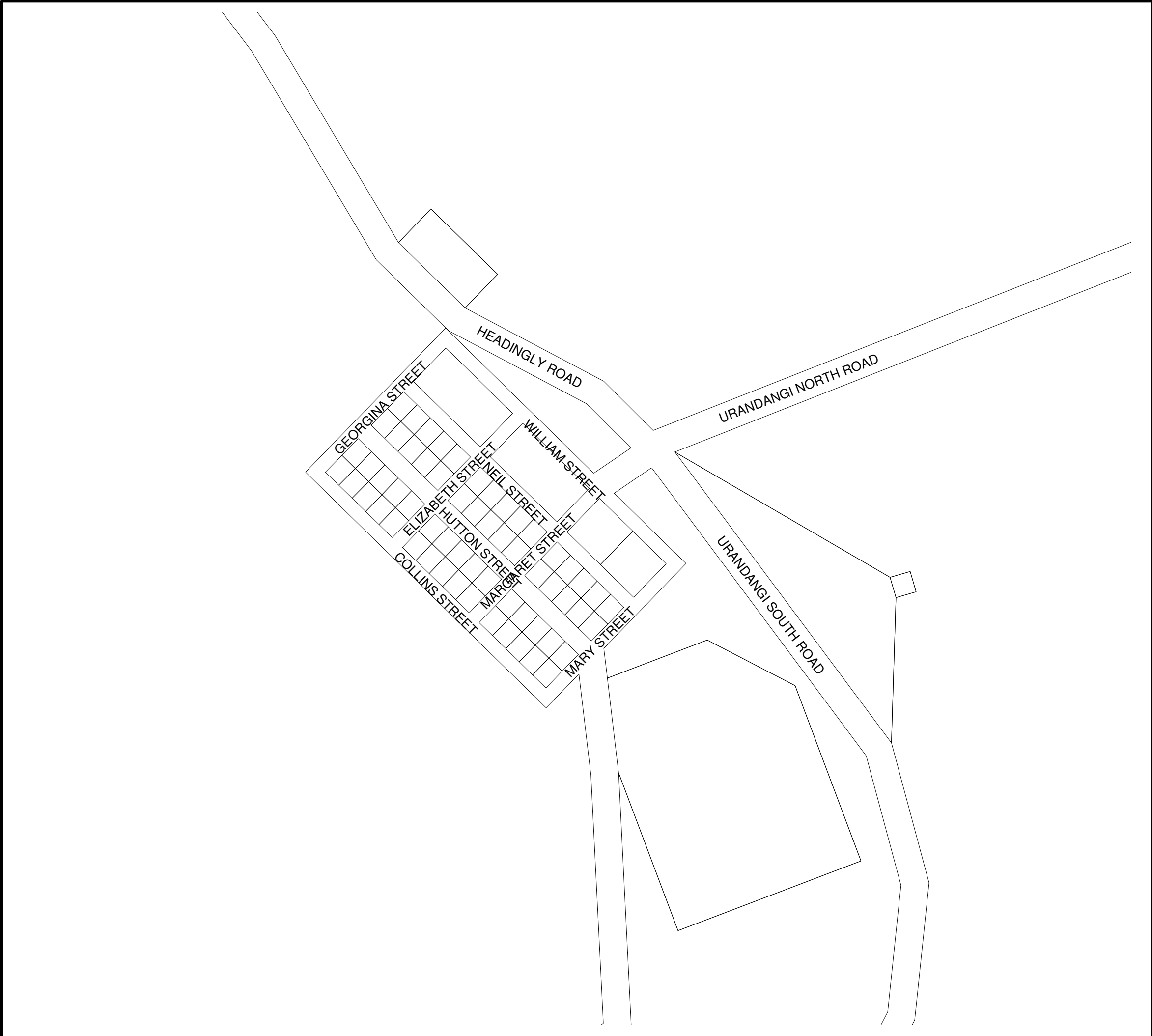



**Disclaimer:**  
Queensland Digital Cadastral Data Base  
Based on or contains data provided by the State of Queensland (Department of Environment and Resource Management) [2010]. In consideration of the State permitting use of this data you acknowledge and agree that the State gives no warranty in relation to the data (including accuracy, reliability, completeness, currency to suitability) and accepts no liability (including without limitation, liability in negligence) for any loss, damage or costs (including consequential damage) relating to any use of the data. Data must not be used for direct marketing or be used in breach of the privacy laws.  
General  
The Infrastructure Data shown on this map has been provided by Council and / or the State of Queensland. In this regard, Campbell Higginson Town Planning makes no guarantees, either expressed or implied as to the completeness, accuracy or correctness of the data nor accepts any liability arising from any incorrect, incomplete information contained within.

**Legend:**

-  Property Boundary
-  State Controlled Roads

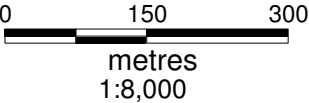

Amendments:

Planning Scheme Version:  
Version 2  
Effective as of 30 January 2015  
Consolidated - Incorporating Amendment No. 1.

© Campbell Higginson Town Planning Pty Ltd 2003 - 2015  
Copyright protects this publication. Campbell Higginson Town Planning has no objection to this material being reproduced, made available online or electronically but only if it is recognized as the owner of the copyright and this material remains unaltered.

**BOULIA SHIRE COUNCIL  
TRUNK INFRASTRUCTURE  
TRANSPORT**

**TOWN OF URANDANGI**

Drawn by: <b>S.G.S.</b>	Drawing No:  <b>SHEET 8 OF 8</b>
Date: <b>04 - 06 - 12</b>	
Ref: <b>22RDS3</b>	